

COMPLET

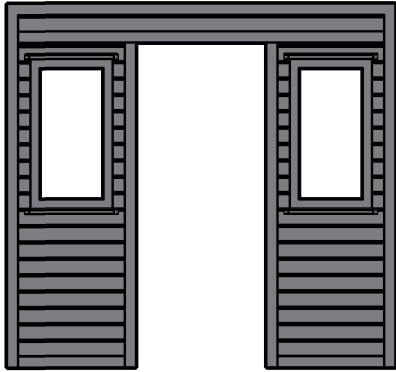

①
1pic



②
1pic

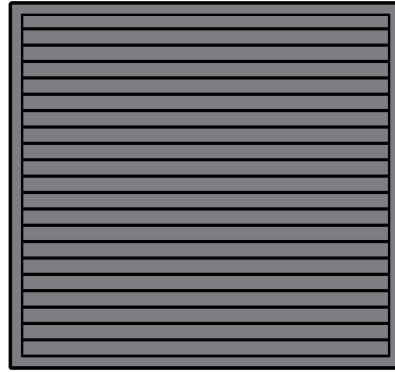

③
1pic

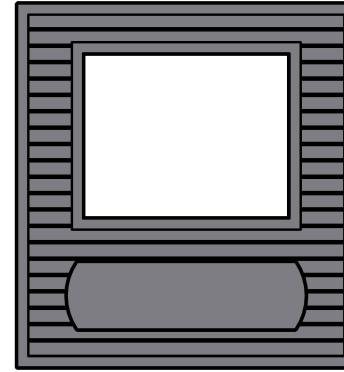

④
1pic

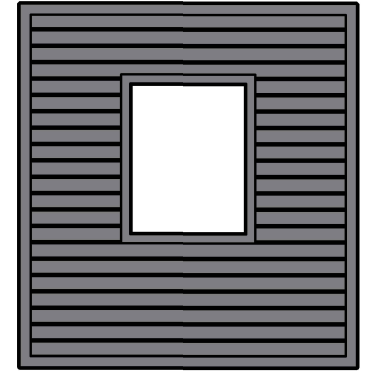

⑤
2pic

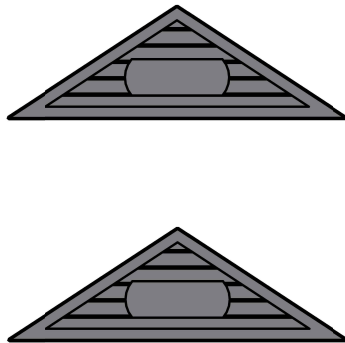

⑥
1pic

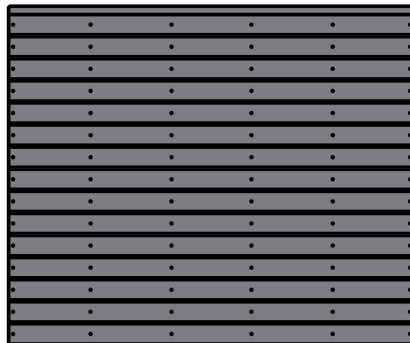

⑦
2pic

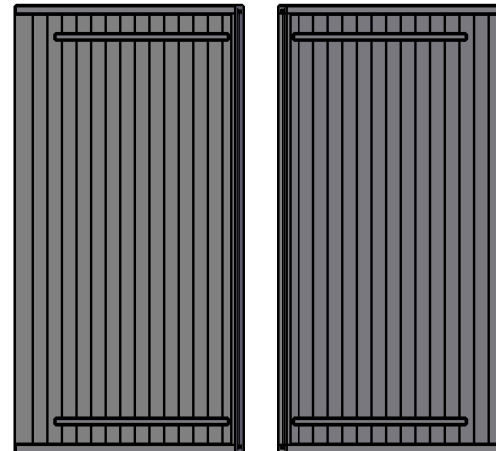

⑧
1pic



⑨
2pic

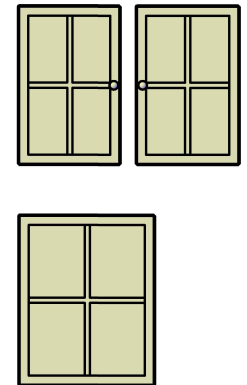

20
1pic

⑩
4pic



⑪
1pic



⑫
4pic

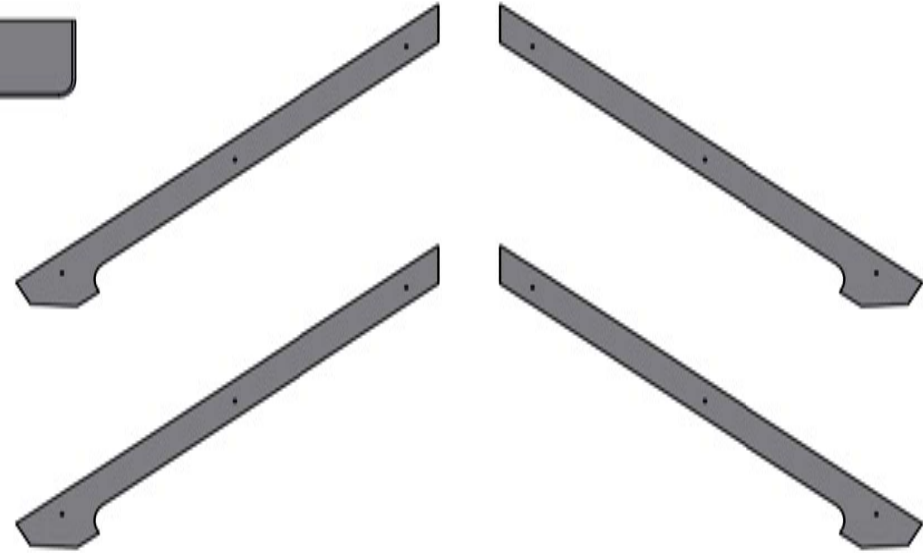

⑬
2pic

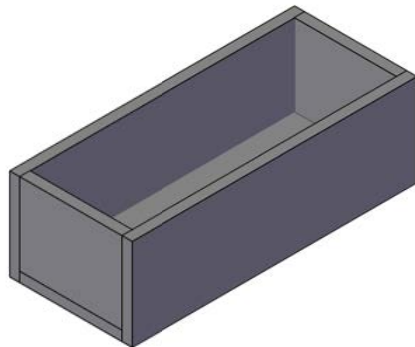

⑭
1pic

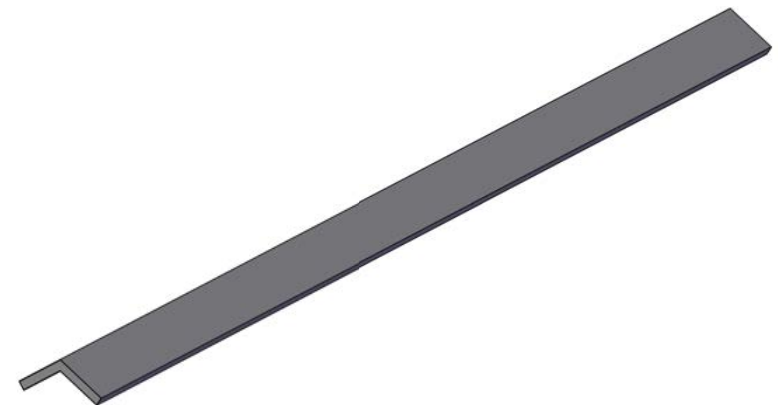

⑮
2pic

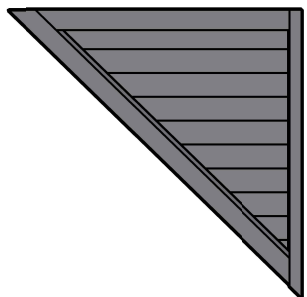
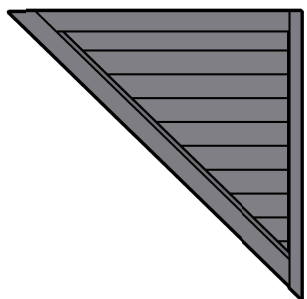

⑯
1pic

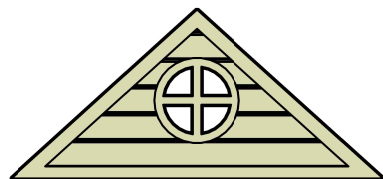

⑰
2pic

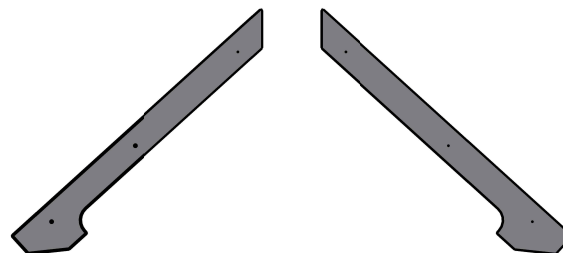

⑱
1pic

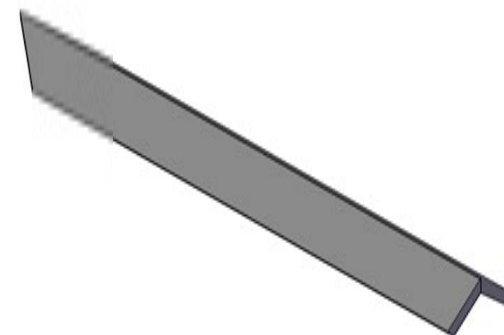

⑲
2pic

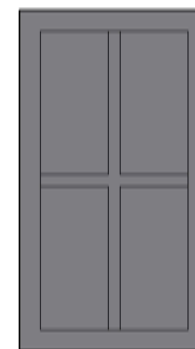

⑳
2pic



㉑
1pic



㉒
1pic



㉓
1pic



M3*18
80pic



M4*20
80pic



M4*35
10pic



M4*50
50pic



P1
12pic



P2
5pic



P5
12pic



Use M4*35install P2

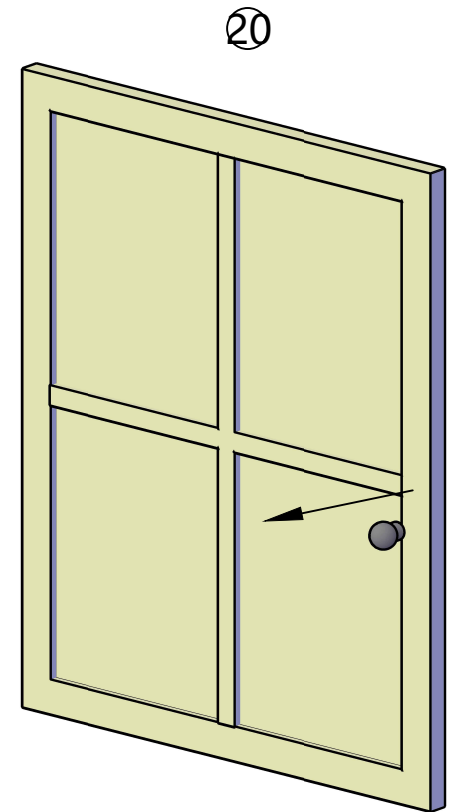
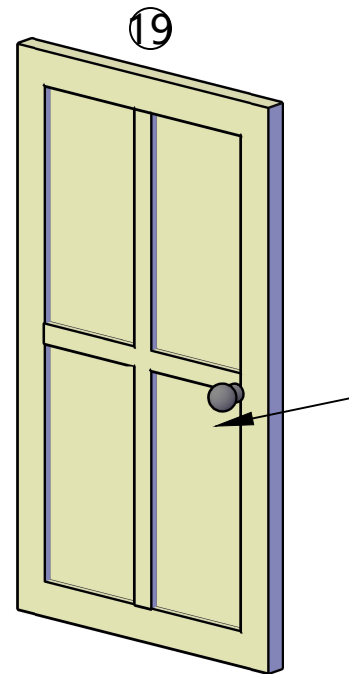
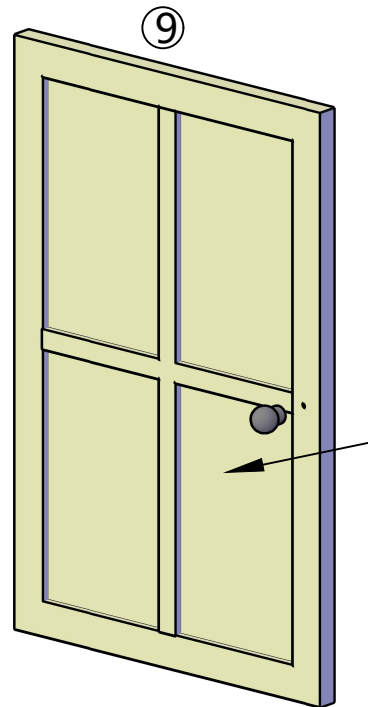
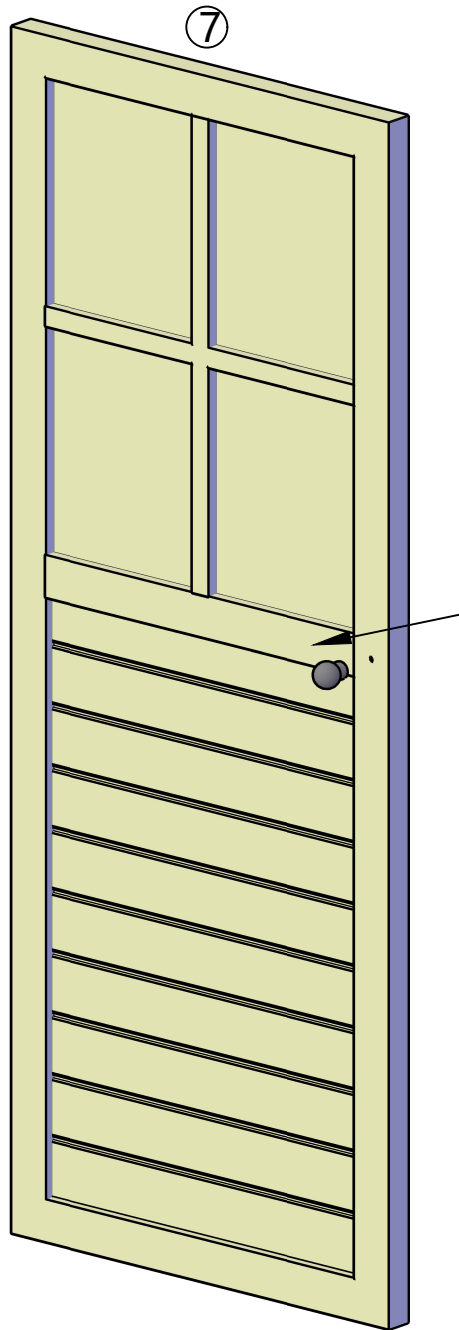

use M3*18,P4,P5 install 19

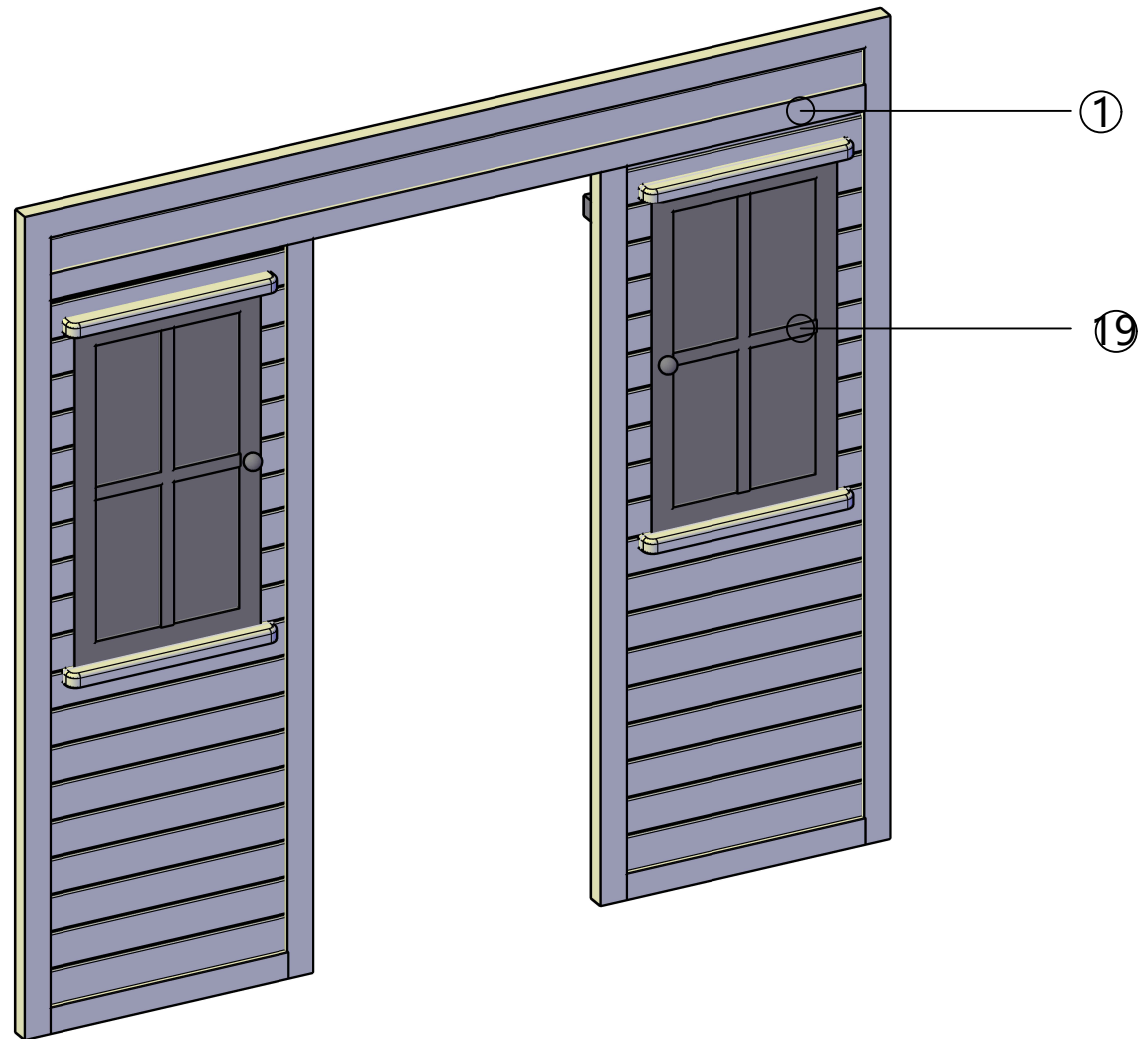

Use M4*20 to install component 13 below the window of part 1. Insert the screws from the back of the wall panel.

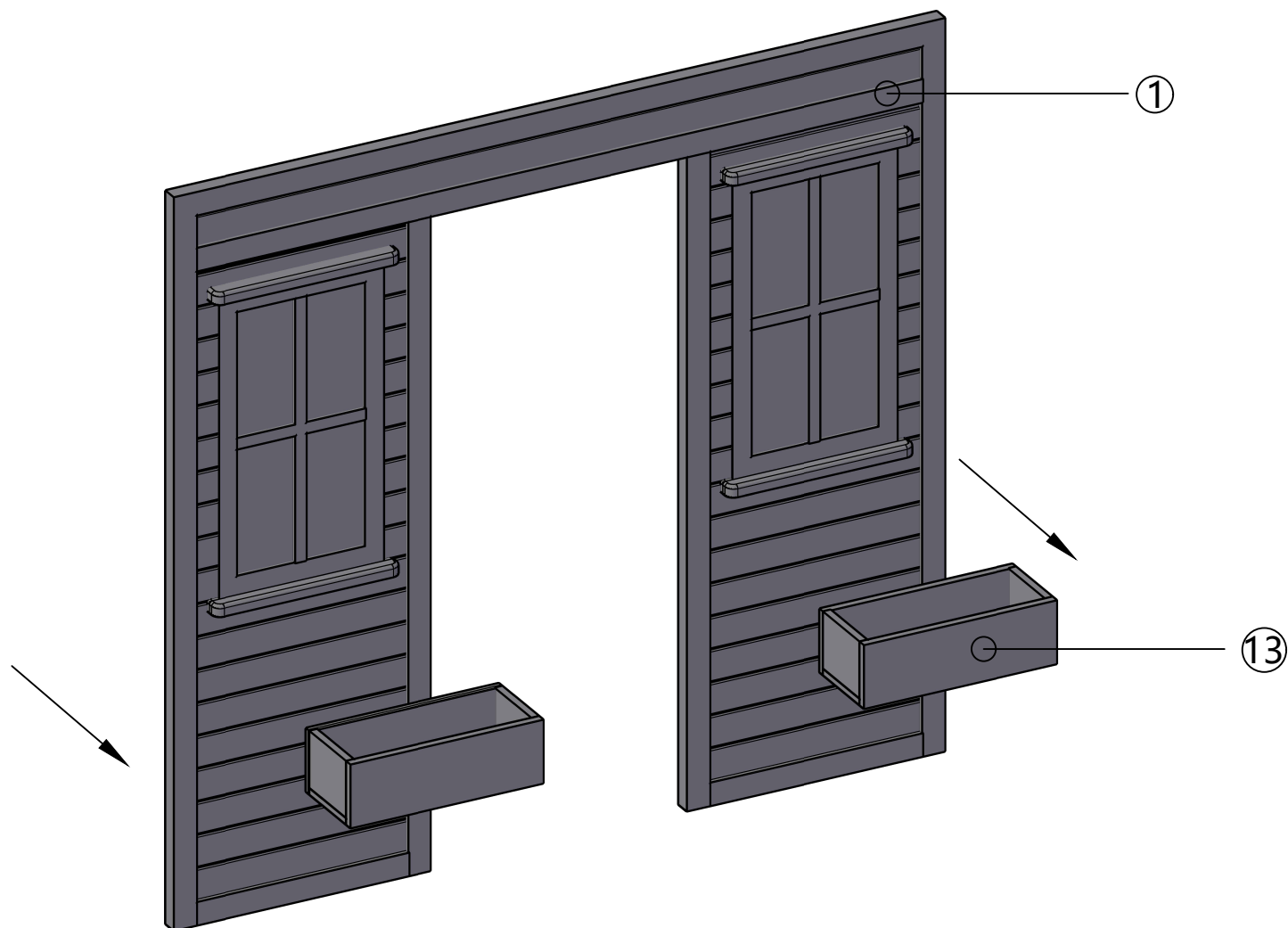

Lay the front wall panel flat on the ground. Install component 8 at a centered and appropriate position using P4 magnetic touch, P5 one-inch hinge, and M3-18.



Install wooden pieces with magnetic touch above the front wall door frame and windows.

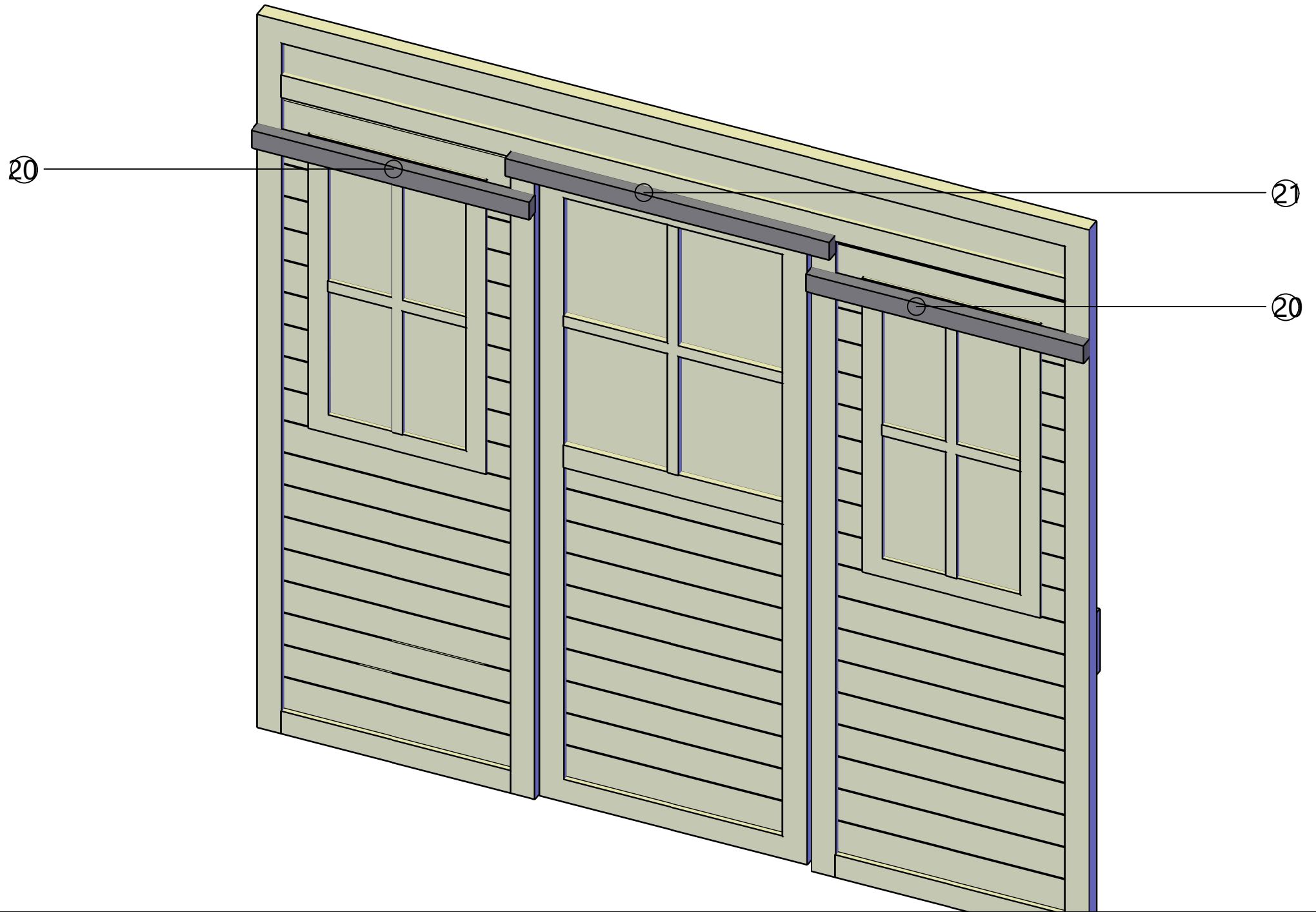

Use M4*20 to install screw No. 10 in the appropriate position on component No. 2, inserting it from the back.

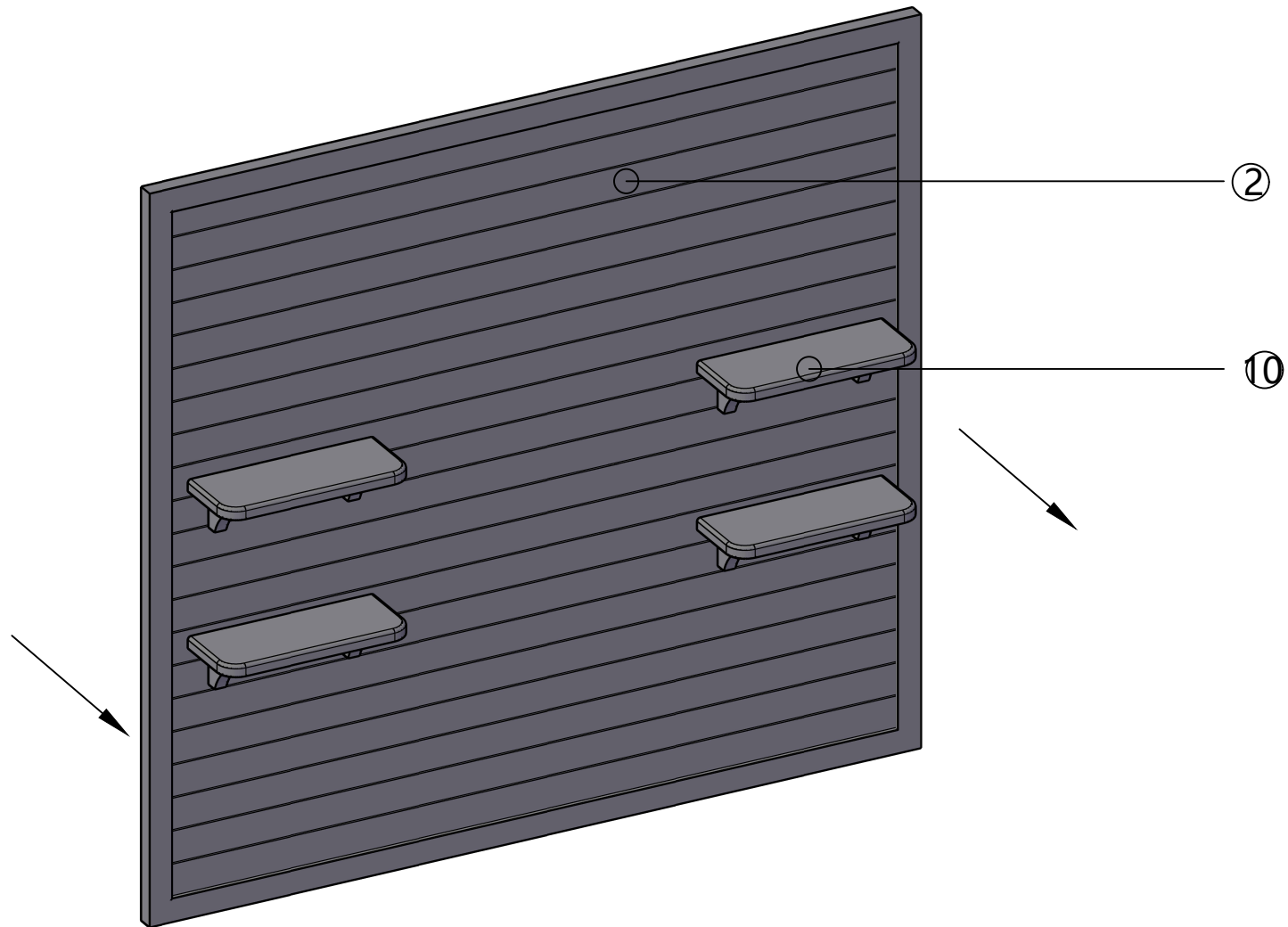

Secure No. 11 onto No. 3 using M4*35.

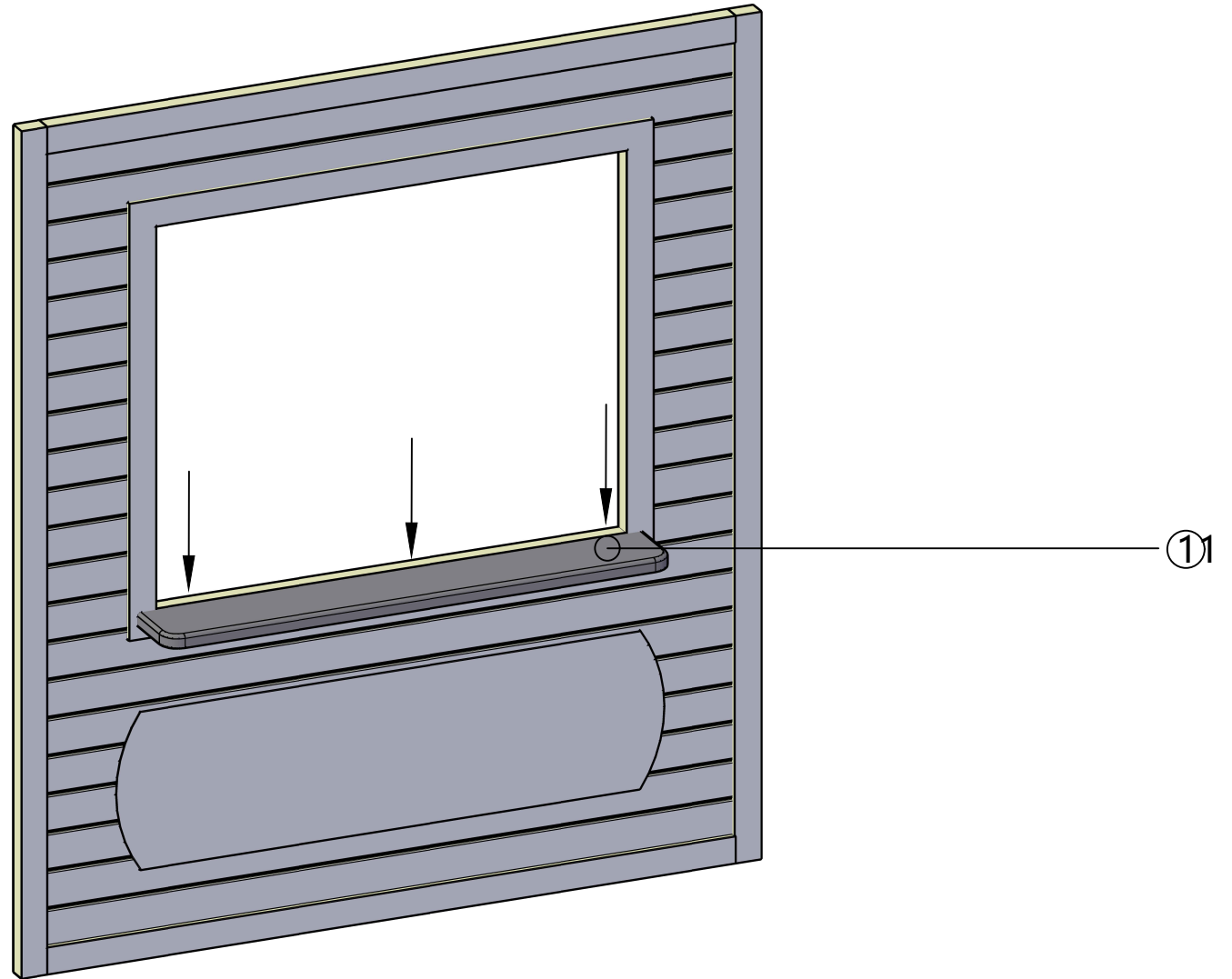

Secure No. 9 onto No. 3 using M435. Use P5 hinge, P4 magnetic touch, and M3*18.

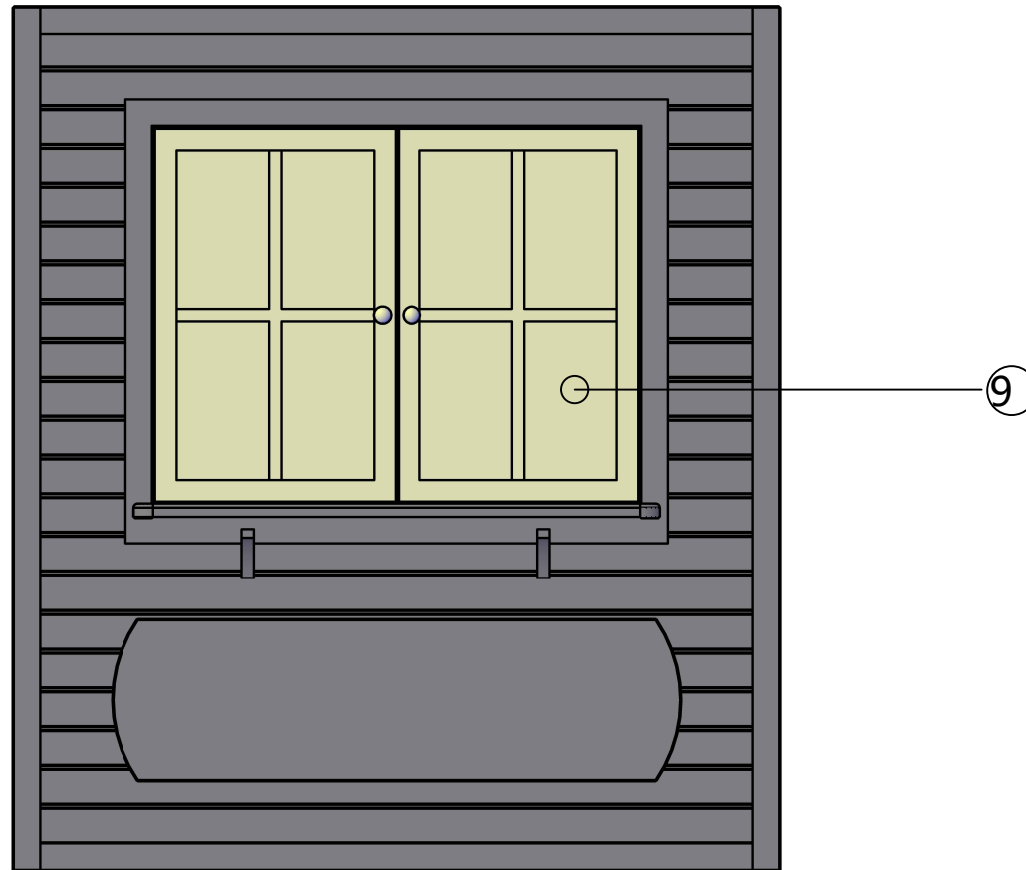

Install wooden pieces with magnetic touch on the back of the wall.

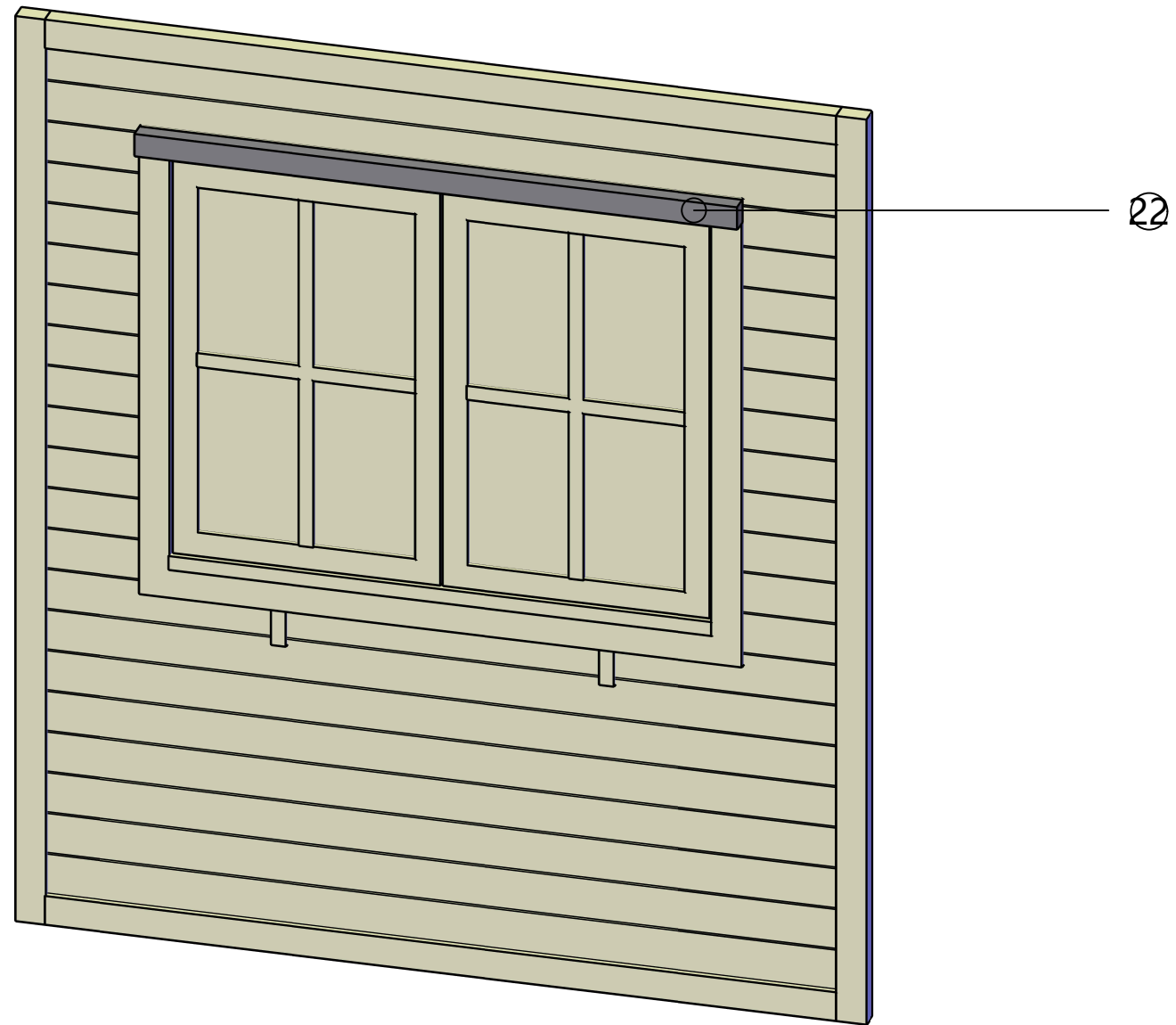

Use M4*50, locating pin, to secure and fix the wall panel.

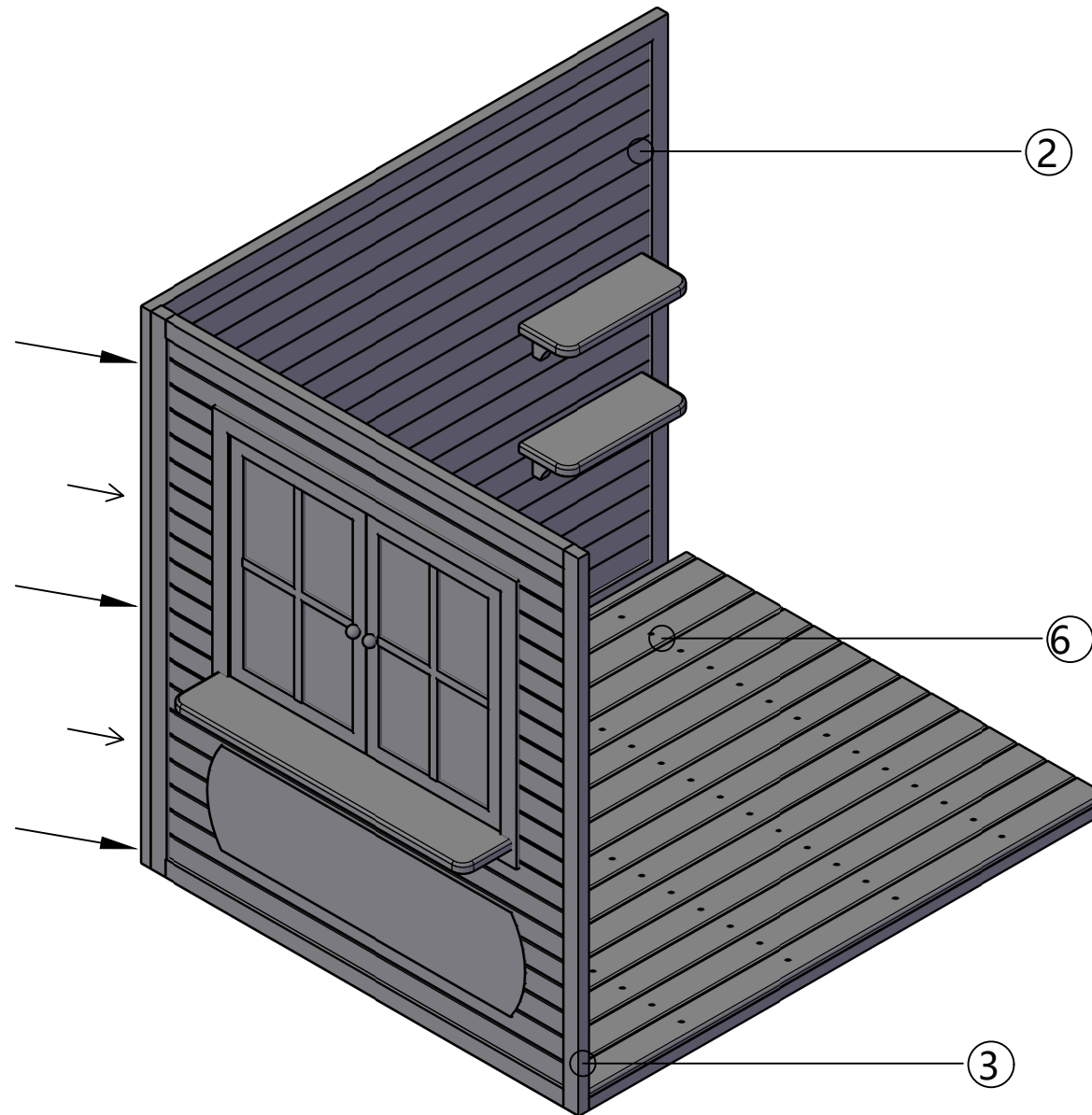

Use M4*50, P1 locating pin, to secure and fix the wall panel.

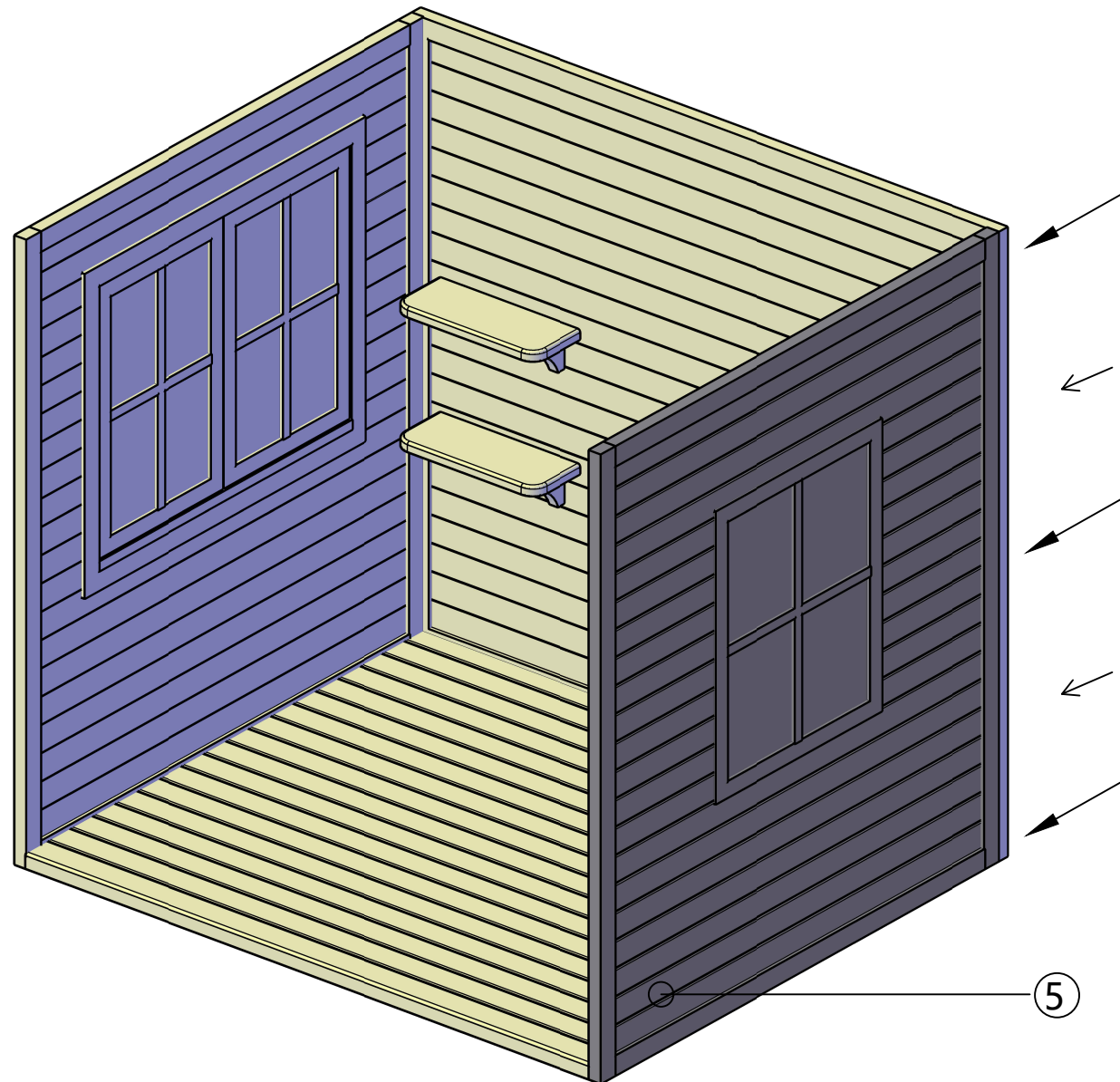

Use M4*50, P1 locating pin, to secure and fix the wall panel.

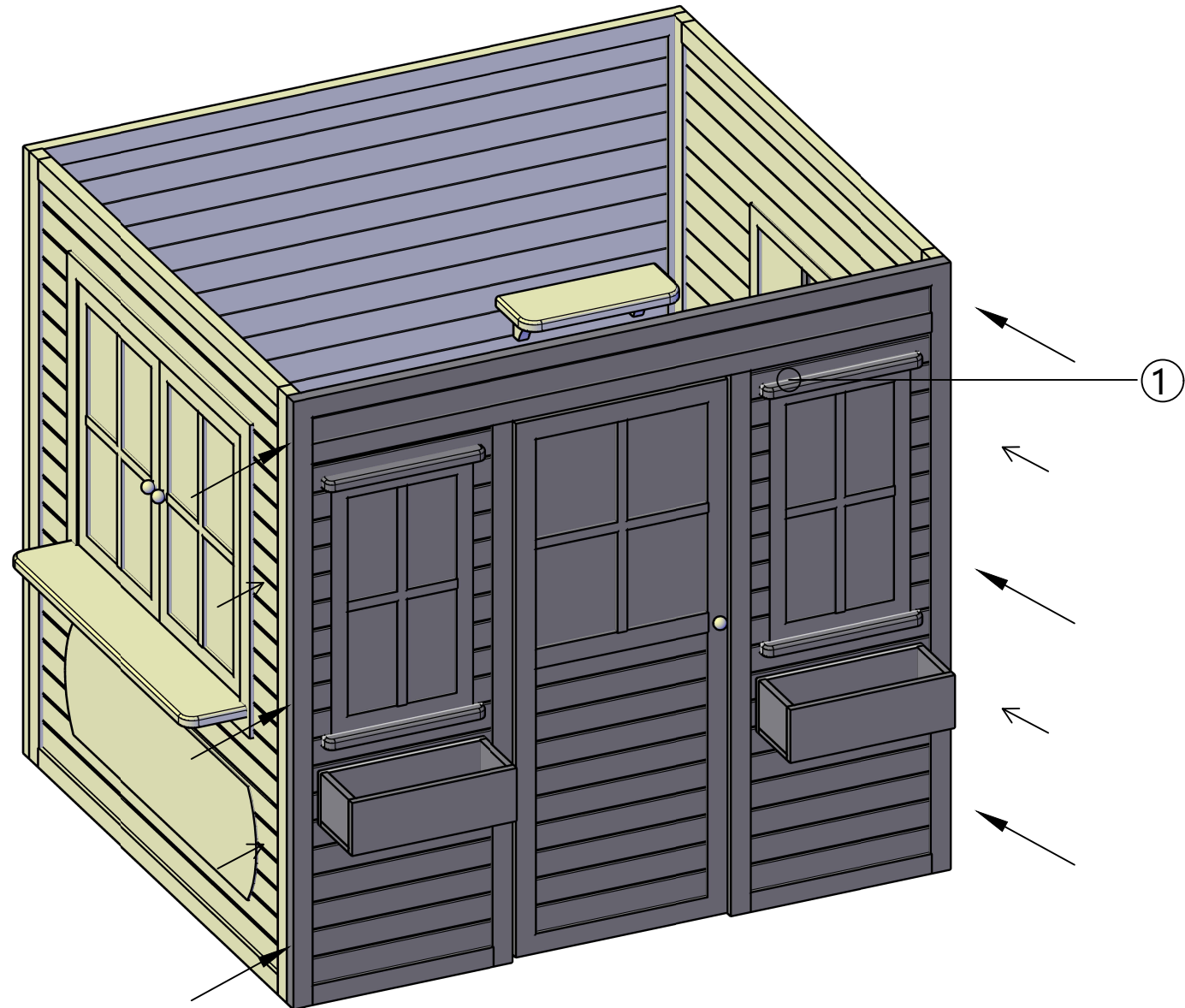

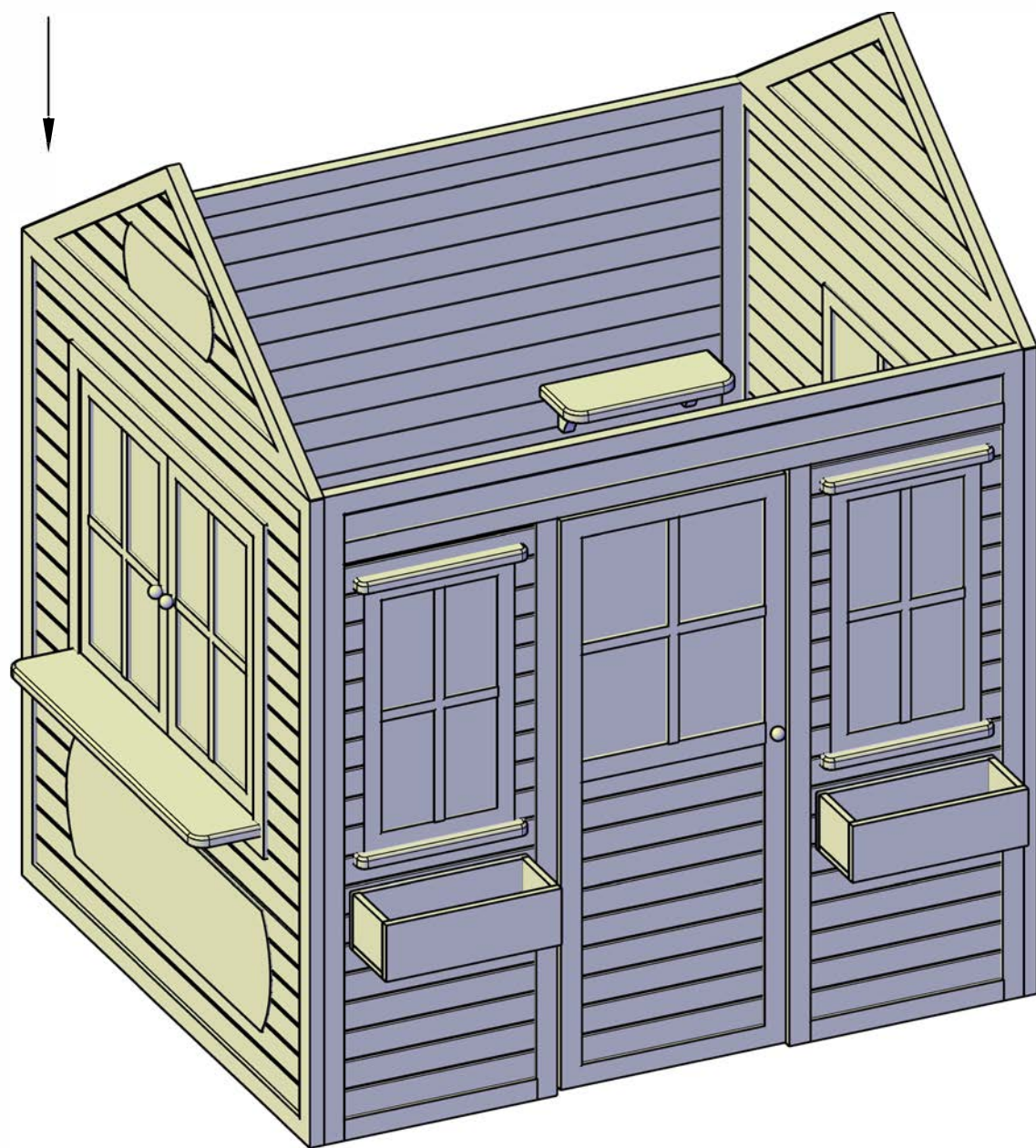

Use M4*50 screws from the wooden block at the bottom of the wall to tightly secure the wall and the floor as one unit.

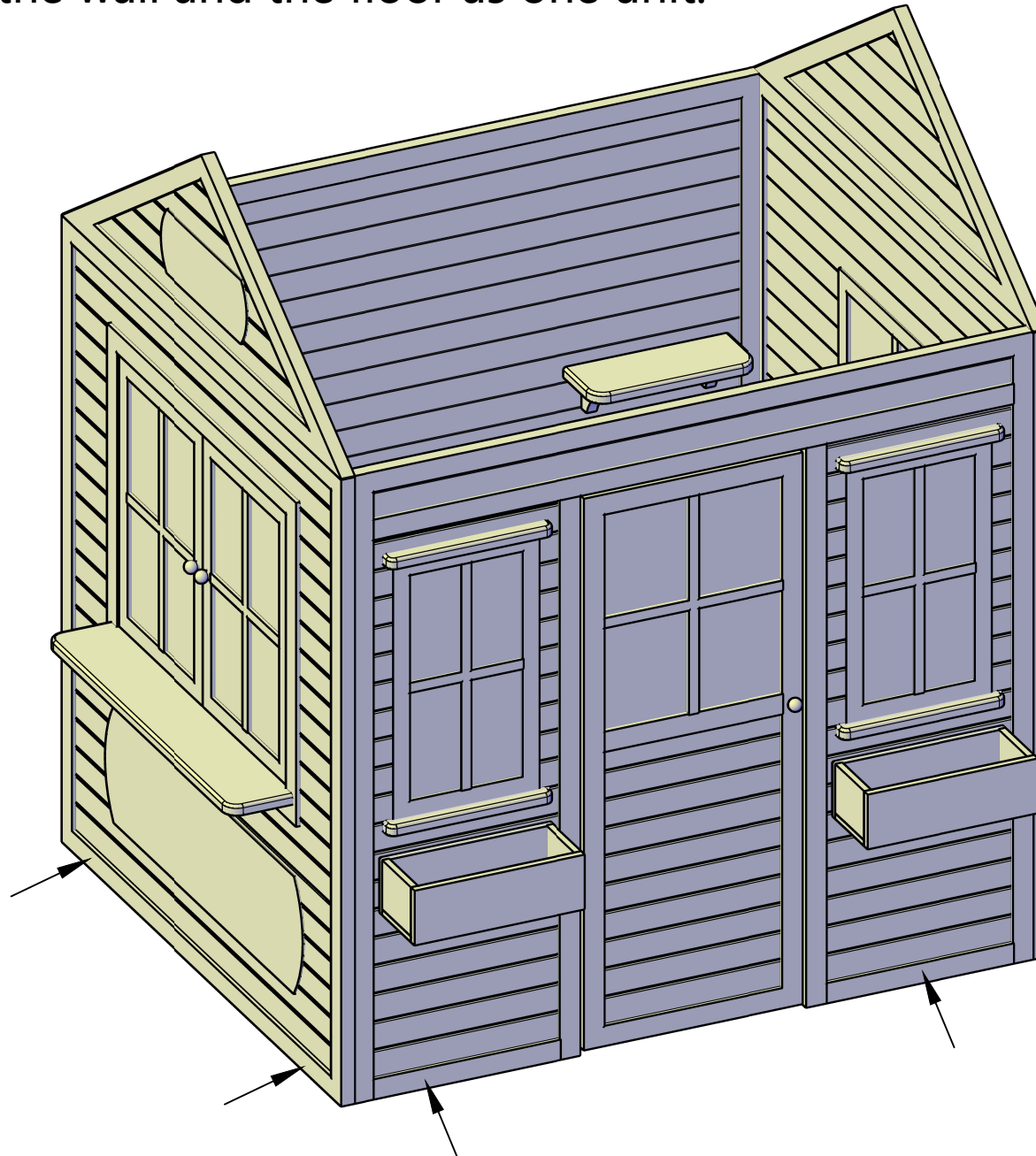

Secure No. 7 using M4*50.

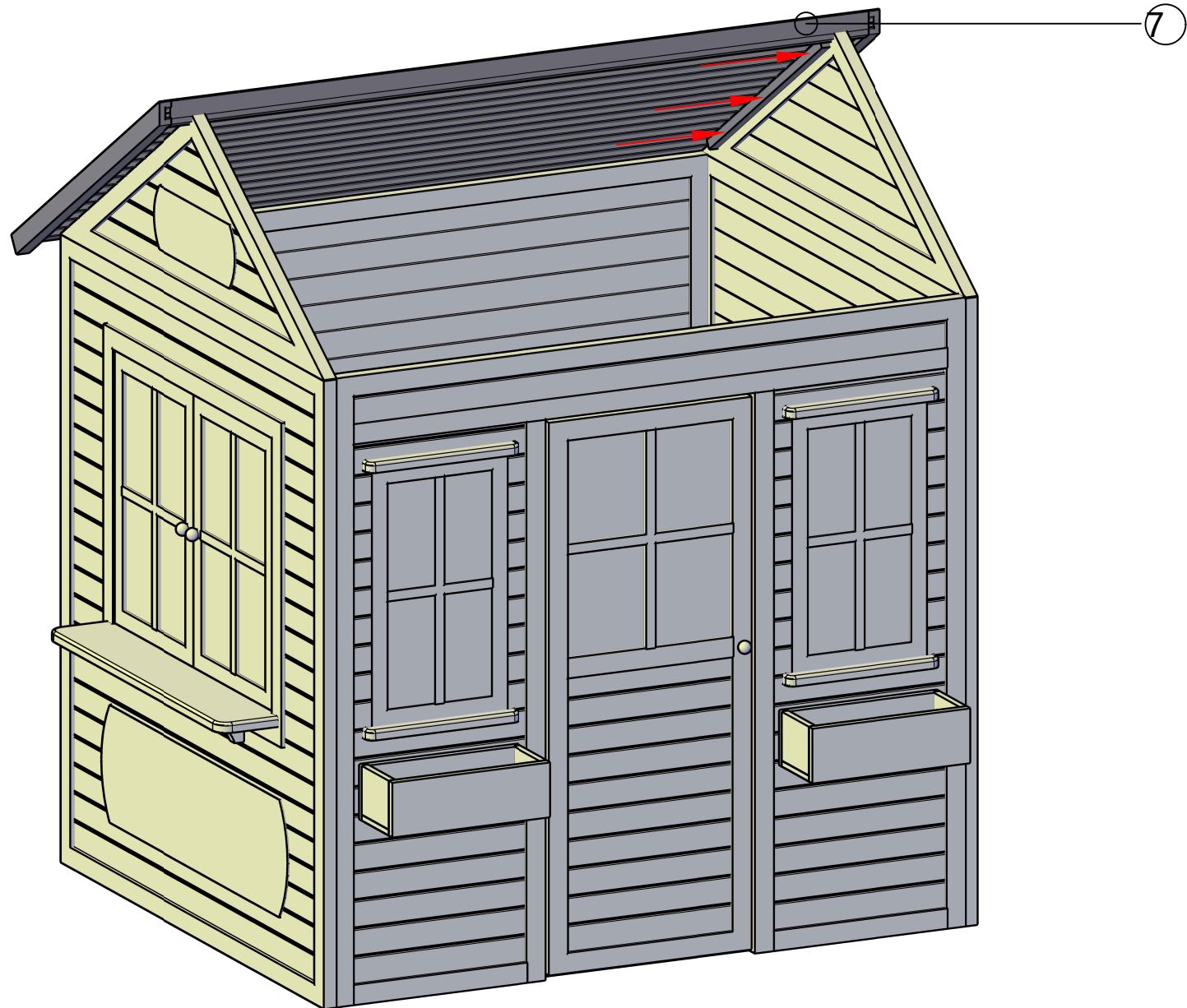

Secure No. 12 using M4*20.
Secure No. 14 using M4*20.

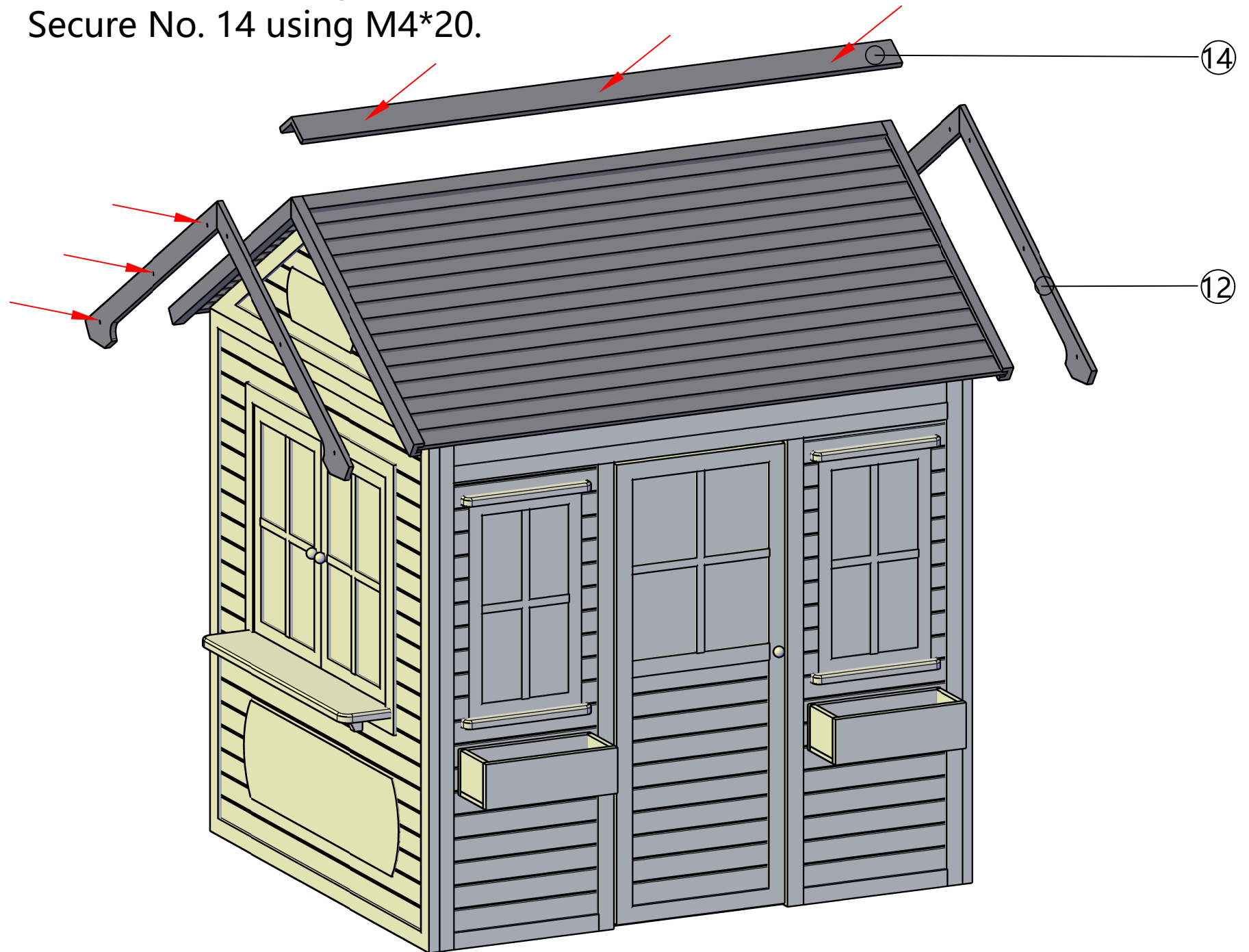

Secure No. 16 using M4*20

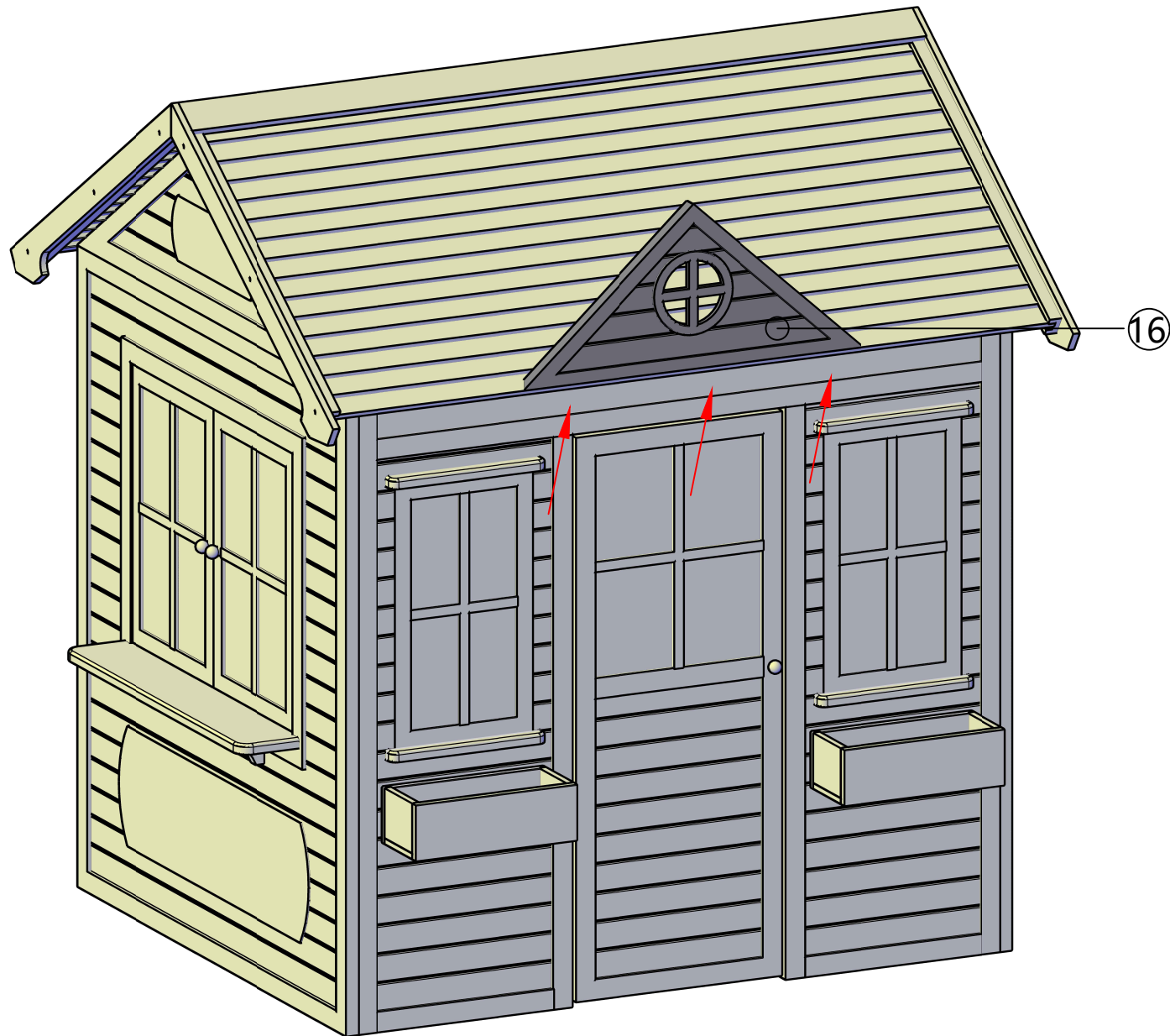

Secure No. 15 using M4*50

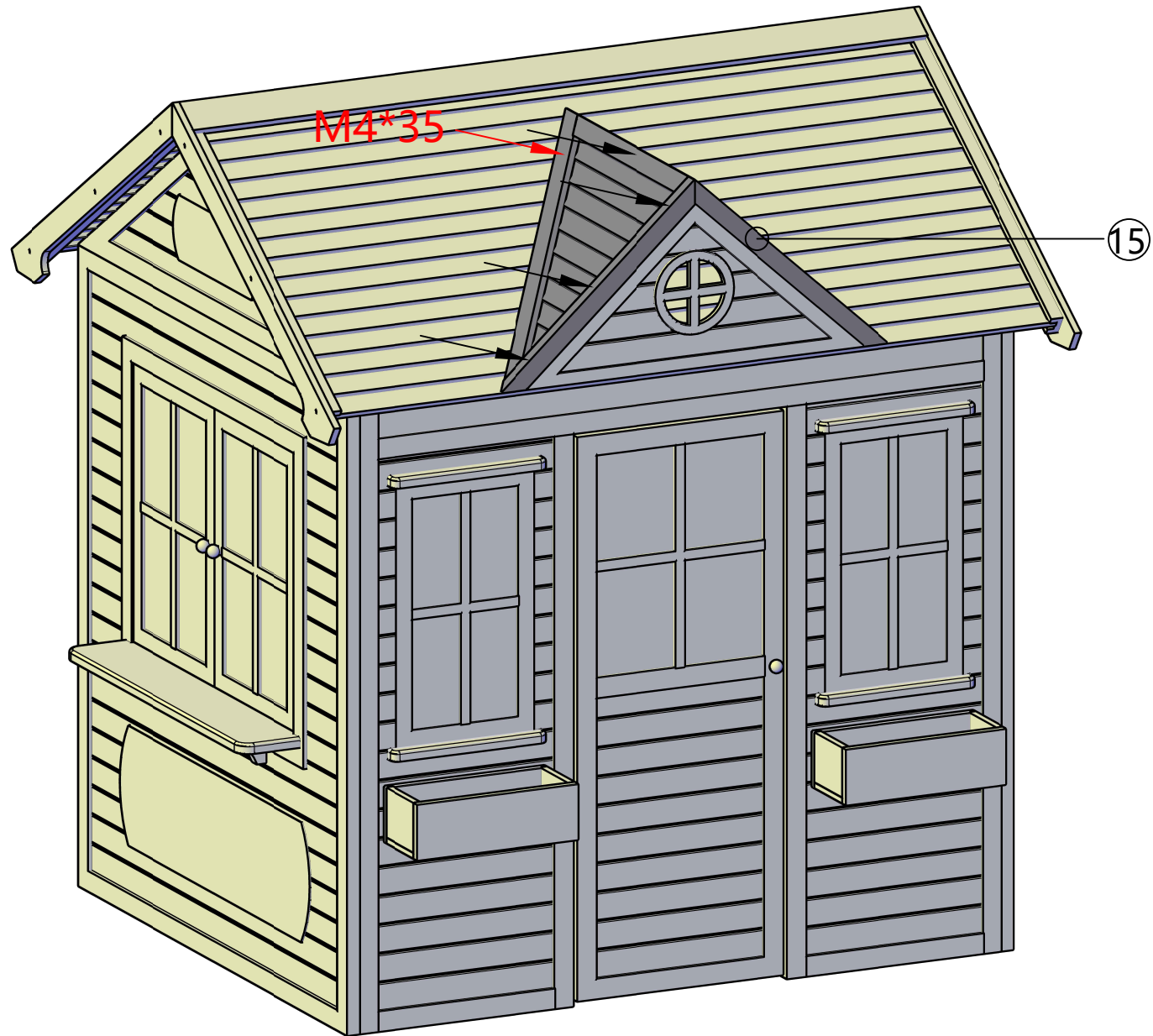

Secure No. 17 and No. 18 using M4*20.

