

# **AIR TABLE**

## **ASSEMBLY INSTRUCTION**

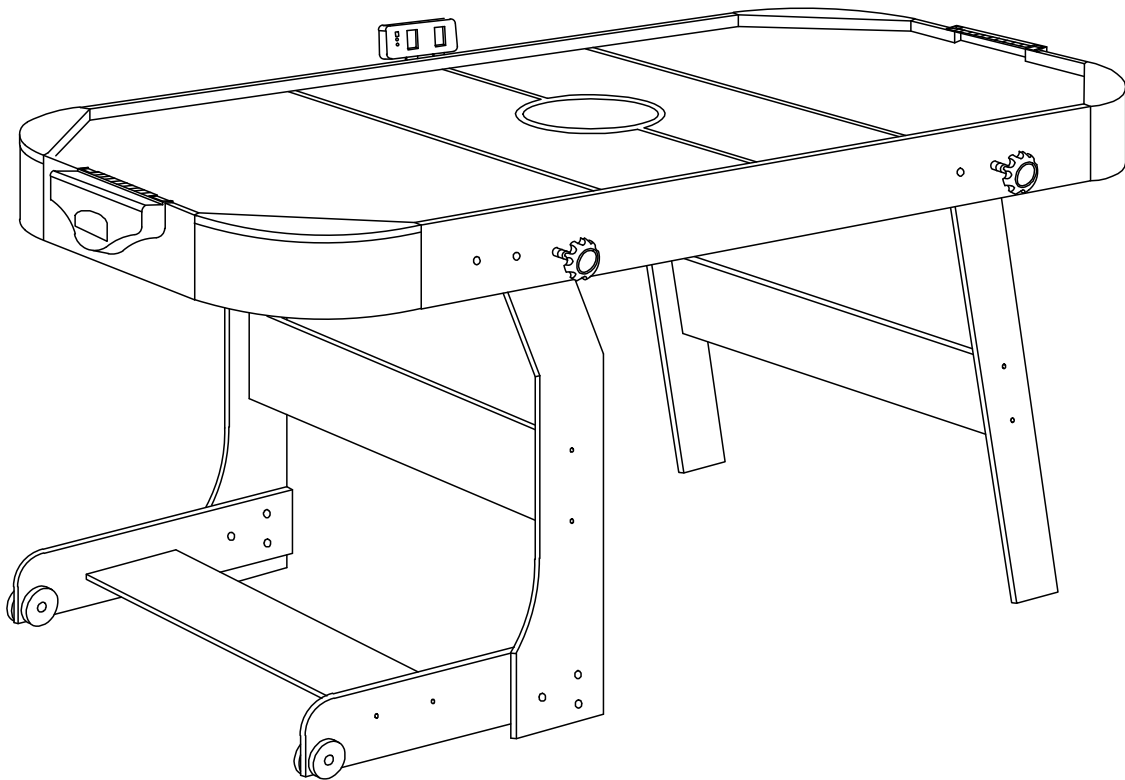

### **ATTENTION:**

Please fold the table up before moving it.

### **IMPORTANT:**

Before attempting assembly, read the instruction carefully to familiarise yourself with all parts and assembly steps

P1

# PARTS IDENTIFIER

P1

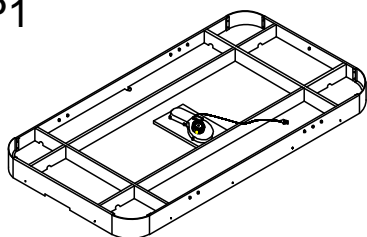

Main Cabinet  
1pc

P2

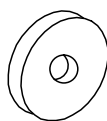

Plastic Caster  
4pcs

P3



Caster Cover  
4pcs

P4A



Angled Leg A  
1pc

P4B

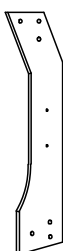

Angled Leg B  
1pc

P5A

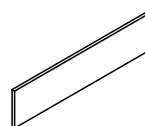

818mm  
LEG PANELS  
1pcs

P5B

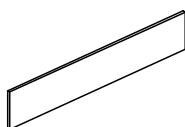

854mm  
LEG PANELS  
2pcs

P6A

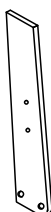

Straight Leg A  
1pc

P6B



Straight Leg B  
1pc

P7A

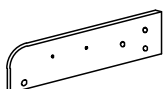

Straight Leg A  
1pc

P7B

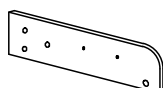

Straight Leg B  
1pc

P8

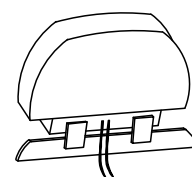

ELECTRONIC SCORER  
1set

P9

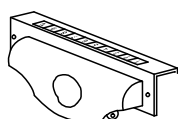

SCORER  
2pcs

P10

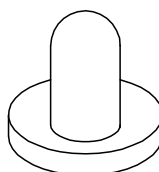

HOCKEY STRIKER  
2set

P11

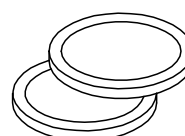

HOCKEY PUCK  
2set

# PARTS IDENTIFIER

P2

H1

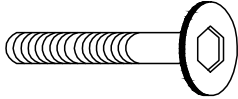

5/16"x1-4/5" BOLT  
4pcs

H2



5/16" Flat Washer  
18pcs

H3

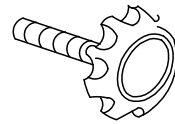

Handle Bolt  
4pcs

H4



5/16" LOCK NUT  
4pcs

H5

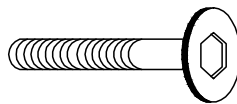

5/16"x1-1/2" BOLT  
6pcs

H6

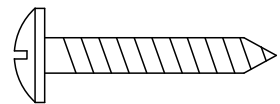

T4x45mm Screw  
12pcs

H7

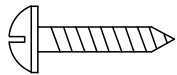

T4x15mm  
ROUND Head Screw  
14pcs

H8

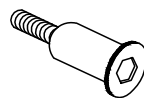

BOLTS  
2pcs

H9

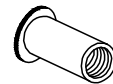

BOLTS NUT  
2pcs

H10



TOOL  
2pcs

H11

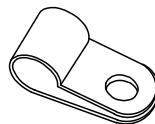

WIRE CLAMP  
3 pcs

H11

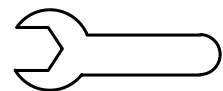

TOOL  
1pcs

WARNING: TWO ADULTS NEEDED TO ASSEMBLE THE POOL TABLE

## ATTENTION:

Find a clean, level place to start assembling the pool table. We recommend placing cardboard or carpet underneath before installation to protect the parts during assembly.

Before assembling the table, remove the protective paper from the table.

FIG.1

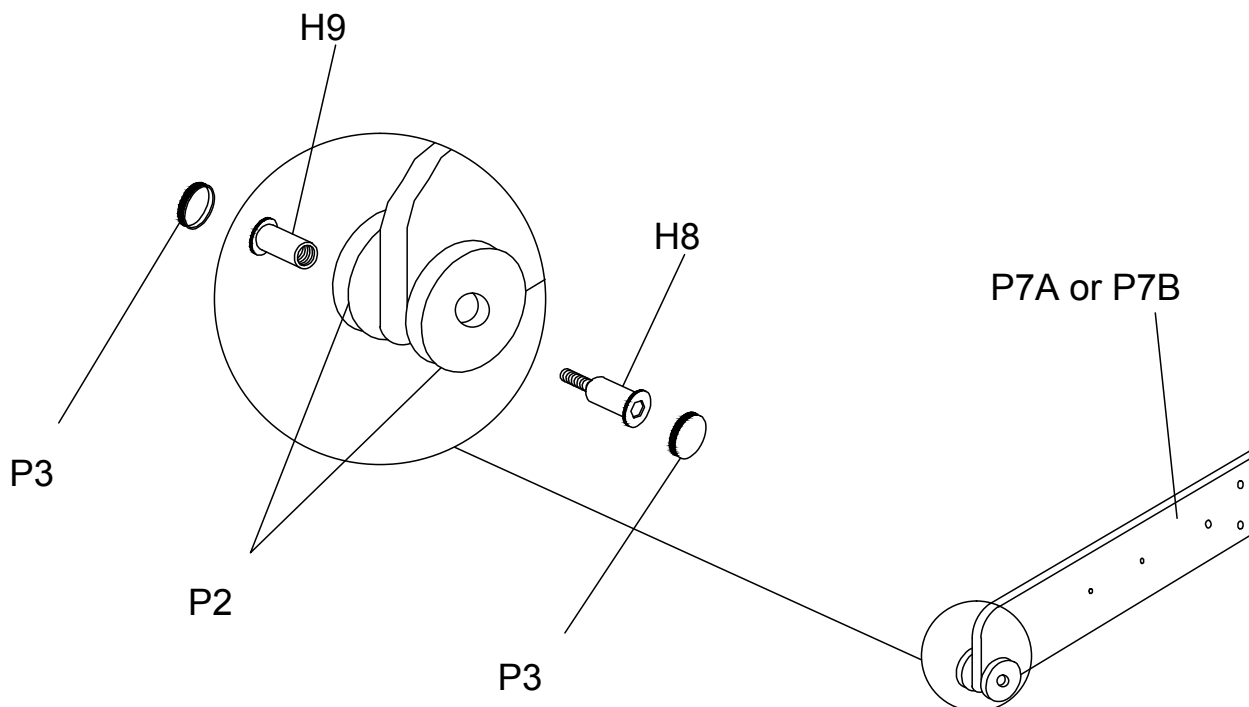

ASSEMBLY INSTRUCTION  
WARNING: TWO ADULTS NEEDED TO ASSEMBLE THE POOL TABLE

FIG.2

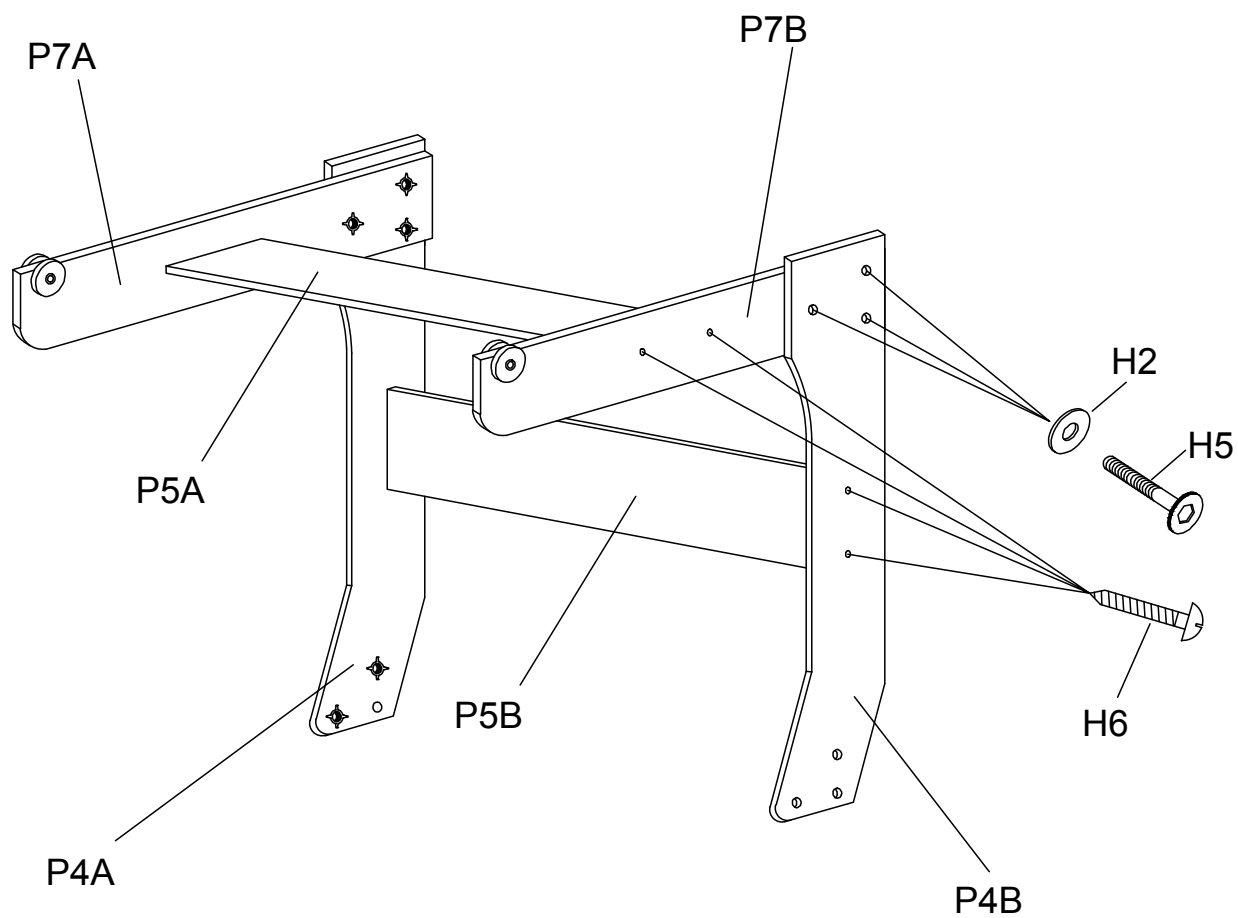
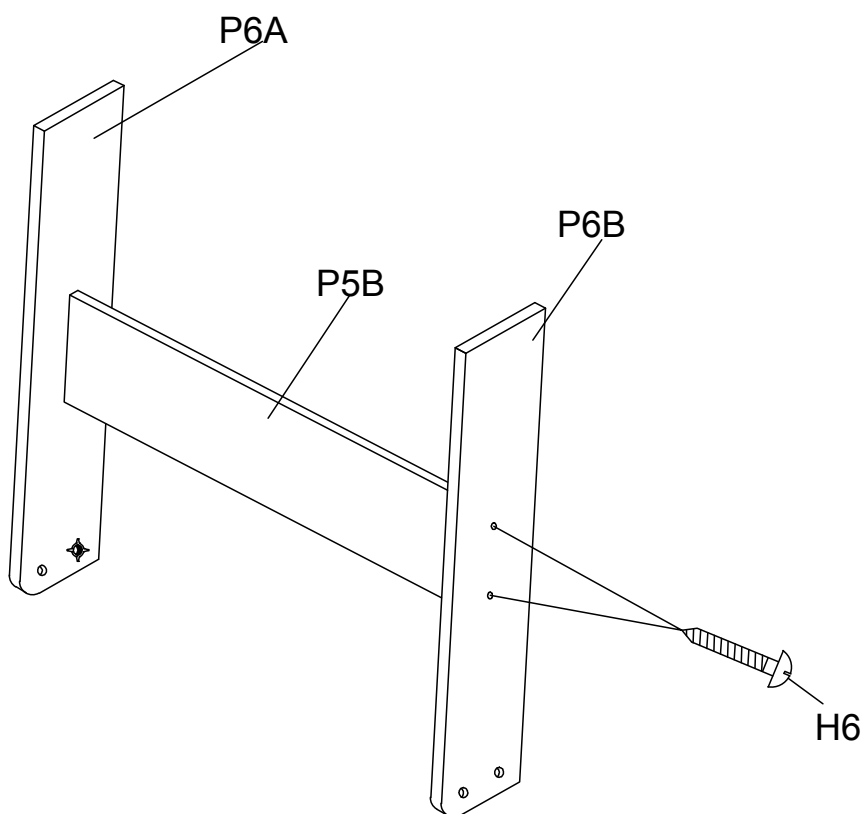

FIG.3



## ASSEMBLY INSTRUCTION

WARNING: TWO ADULTS NEEDED TO ASSEMBLE THE POOL TABLE

FIG.4

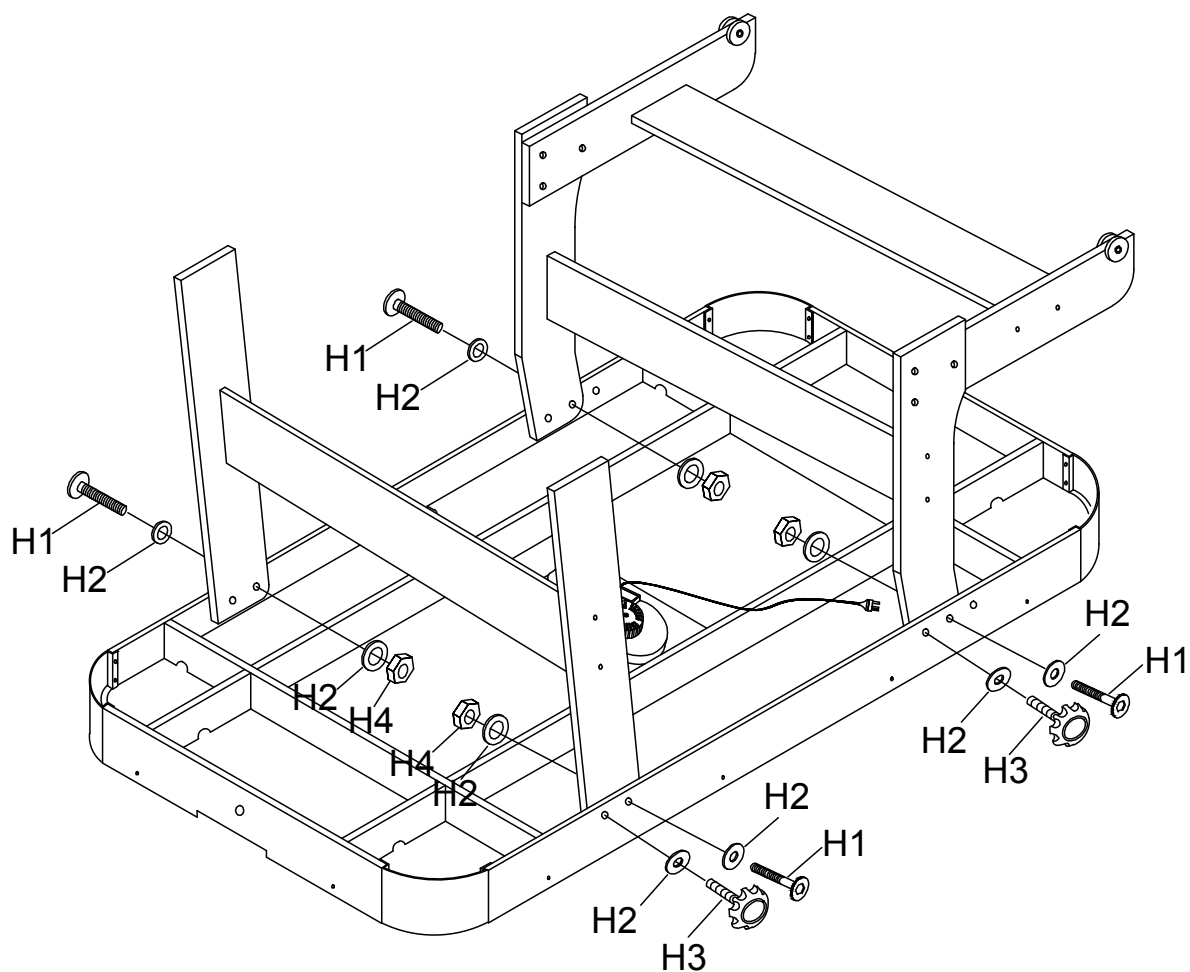

WARNING: TWO ADULTS NEEDED TO ASSEMBLE THE POOL TABLE

FIG.5

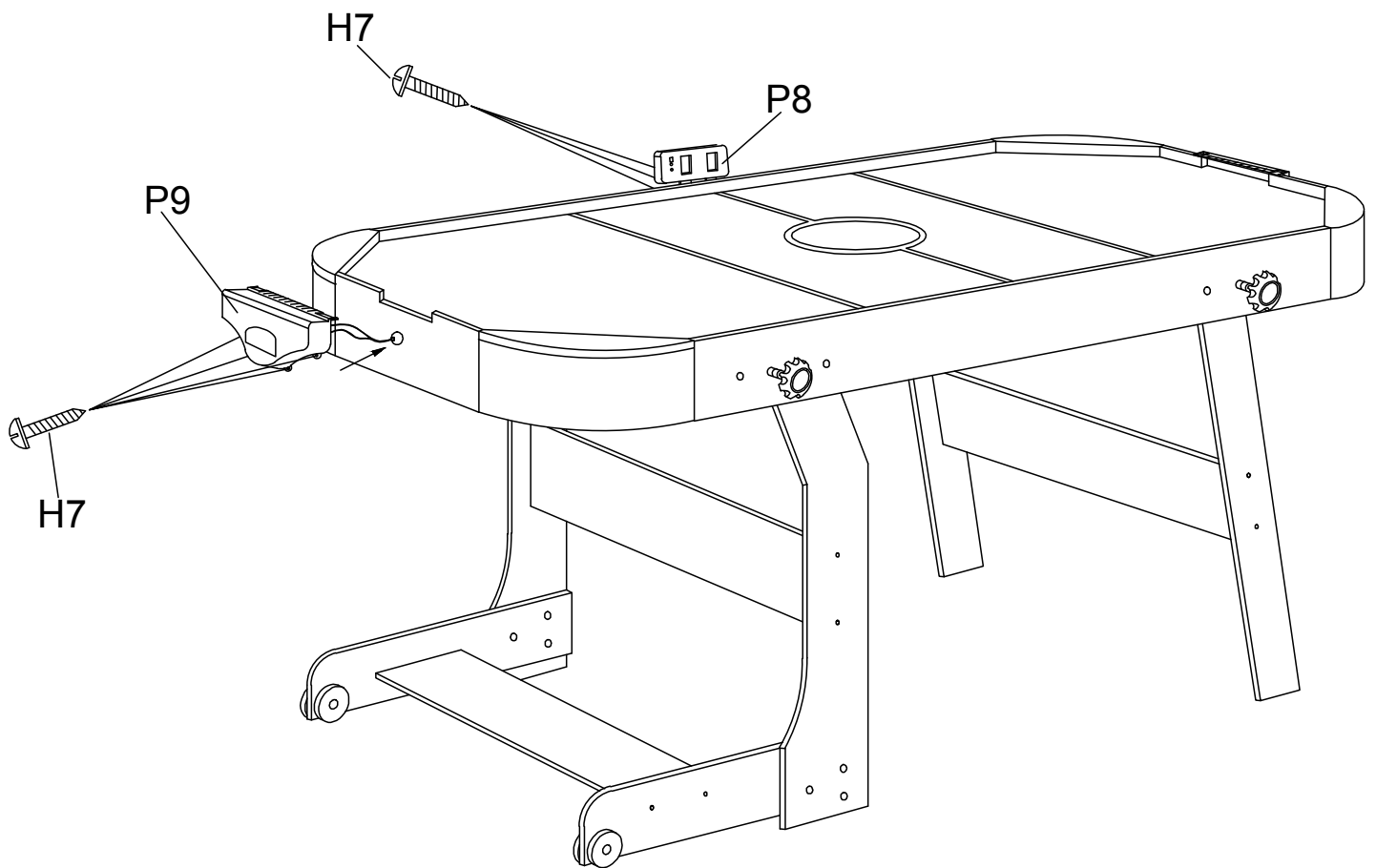

## ASSEMBLY INSTRUCTION

WARNING: TWO ADULTS NEEDED TO ASSEMBLE THE POOL TABLE

